

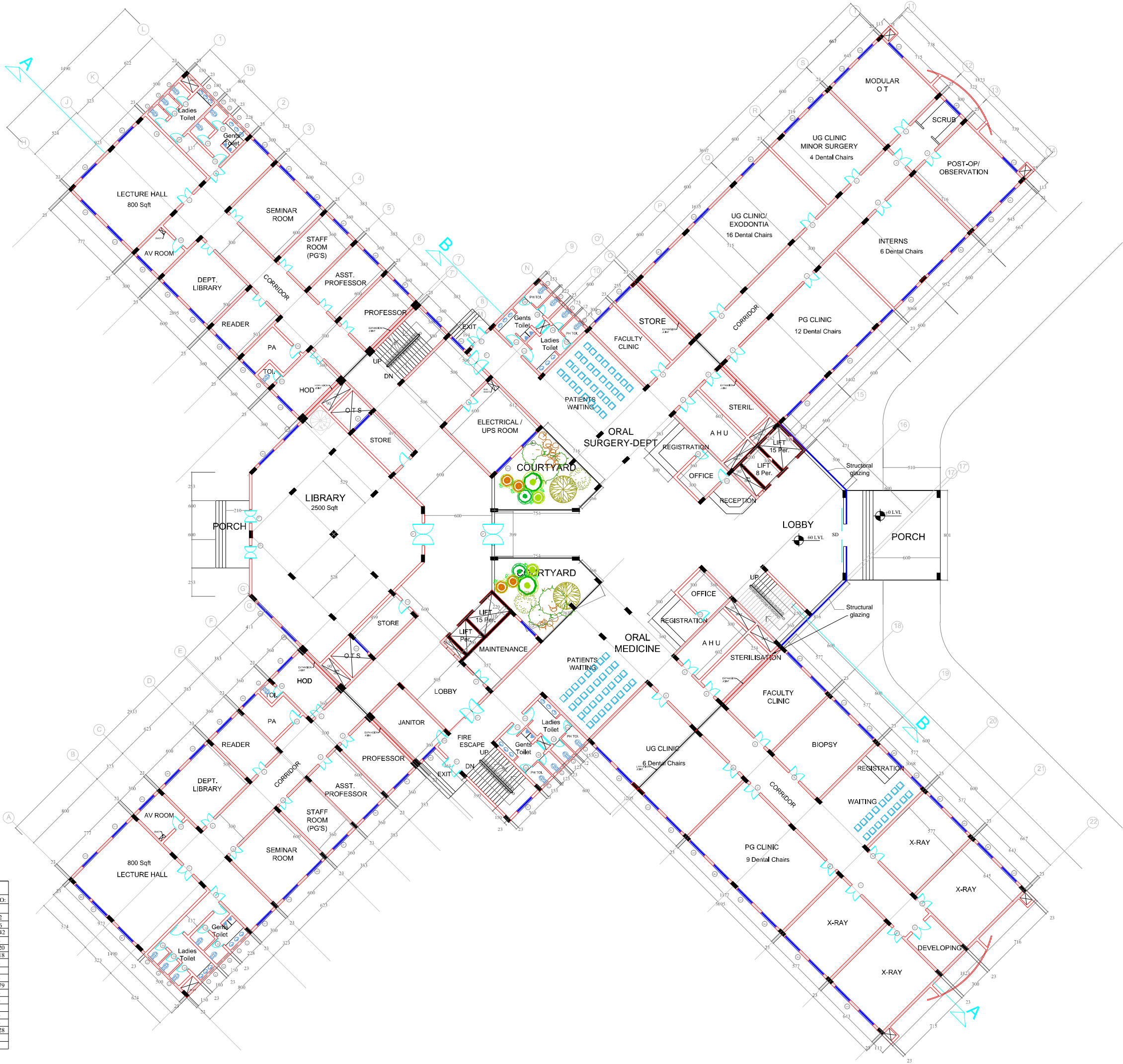

SCHEDULE OF OPENINGS				
MARK	SIZE	TYPE	NO.	
DOORS				
D*	180x225	WOOD	2	
D*	150x225	WOOD	6	
D	120x225	WOOD	6	
D1	100x210	WOOD	-	
D3	90x210	WOOD	20	
D2	80x210	PVC	18	
SD	300 x 240	GLASS	1	
WINDOWS				
FW	60 x 180	ALUM	-	
W1	180 x 150	ALUM	79	
W2	150 x 150	ALUM	-	
W3	120 x 150	ALUM	-	
FG	150 x 120	ALUM	-	
FG-1	90 x 120	ALUM	-	
V	90 x 60	ALUM	28	



CONSULTANTS:



HLL LIFE CARE LTD.

(A Government of India Enterprise)

INFRASTRUCTURE DEVELOPMENT DIVISION

VETAMUKKU

THIRUVANANTHAPURAM-6

TEL: 0471-2365872, 2365873

FAX: 0471- 2368144

web: www.lifeclhll.com

PROJECT:-

PROPOSED GOVT. DENTAL COLLEGE, THRISSUR

DRAWING:-

GROUND FLOOR PLAN

DRAWN BY:

RAHUL

CHECKED BY:

RVK

SCALE:

NTS

DATE:

28-02-2014

REVISION

AREA

Ground floor	3680 Sqm
First Floor	
Second Floor	
Third Floor	
Fourth Floor	
Terrace Floor	118 Sqm
Total	3798 Sqm

DRAWING NO.

HLL/IDD/DC/TSR/2013-14/A-2

SIGNATURE

ARCHITECTURAL DRAWING

DISCLAIMER : THESE DRAWINGS ARE THE SOLE PROPERTY OF HLL LIFE CARE LTD.

NO CHANGES OR COPIES CAN BE MADE WITHOUT CONSENT.